

# MCT.

Fluted grip knobs

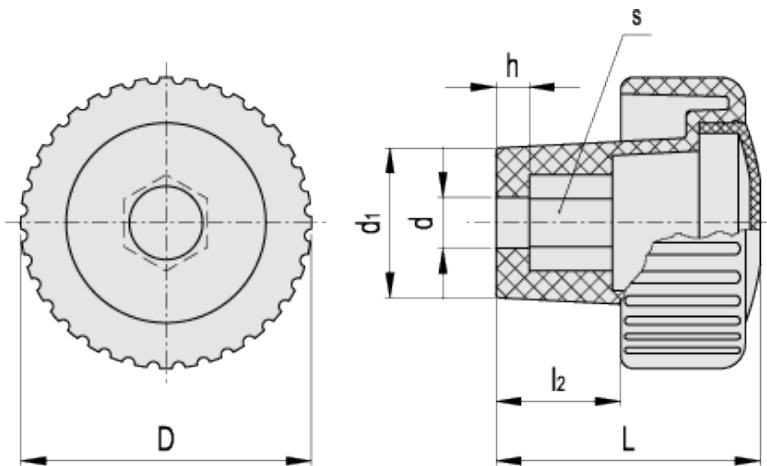

FM Design



## technical informations

### Material

Polyamide based (PA) technopolymer. Resistant to solvents, oils, greases and other chemical agents.

### Colour

Black, matte finish.

### Closing cap

Polypropylene based (PP) technopolymer, orange or black colour, glossy finish with matte central surface, snap-in mounting.

### Standard execution

Assembly by means of hexagon head screws or standard lock nuts (not supplied) to put in place inside the knob by pressing.



*Special executions on request*

- On the surface of the closing cap words, marks, graphic symbols, etc... can be tamproprinted in colours.
- Black closing cap.

*Assembly instructions*

1. The base of the knob should rest on a flat surface.
2. Insert the screw or the lock nut into the knob hole by means of a thrust tool.
3. Push until the insert is completely fitted in.
4. Assemble the snap-in closing cap.

**RIGHT ASSEMBLY**

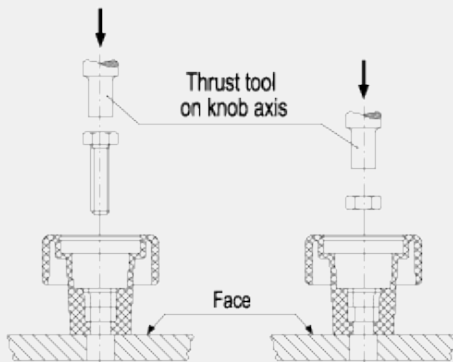

**WRONG ASSEMBLY**

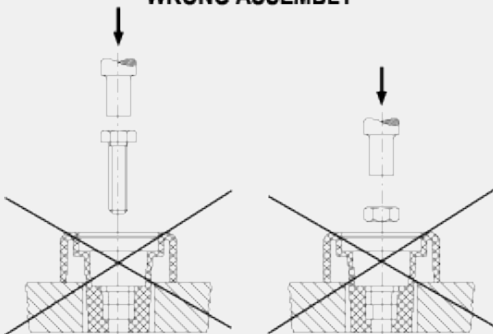

C2  
 RAL2004
  C9  
 RAL9005

Standard Elements		Main dimensions				Mounting hole			Weight
Code	Description	D	L	d <sub>1</sub>	l <sub>2</sub>	d	h	s	g
138711	MCT.35 EH-5-C2	35	32	18	15	5	4	8	12
138712	MCT.35 EH-5-C9	35	32	18	15	5	4	8	12
138721	MCT.35 EH-6-C2	35	32	18	15	6	4	10	11

138722	MCT.35 EH-6-C9	35	32	18	15	6	4	10	11
138731	MCT.35 EH-8-C2	35	32	18	15	8	4	13	10
138732	MCT.35 EH-8-C9	35	32	18	15	8	4	13	10
138751	MCT.50 EH-6-C2	50	40	23	21	6	5	10	23
138752	MCT.50 EH-6-C9	50	40	23	21	6	5	10	23
138761	MCT.50 EH-8-C2	50	40	23	21	8	5	13	22
138762	MCT.50 EH-8-C9	50	40	23	21	8	5	13	22
138771	MCT.50 EH-10-C2	50	40	23	21	10	5	16	21
138772	MCT.50 EH-10-C9	50	40	23	21	10	5	16	21
138791	MCT.70 EH-8-C2	70	71	30.5	40	8	9	13	64
138792	MCT.70 EH-8-C9	70	71	30.5	40	8	9	13	64
138801	MCT.70 EH-10-C2	70	71	30.5	40	10	9	16	63
138802	MCT.70 EH-10-C9	70	71	30.5	40	10	9	16	63
138811	MCT.70 EH-12-C2	70	71	30.5	40	12	9	18	62
138812	MCT.70 EH-12-C9	70	71	30.5	40	12	9	18	62
138821	MCT.70 EH-14-C2	70	71	30.5	40	14	9	21	61
138822	MCT.70 EH-14-C9	70	71	30.5	40	14	9	21	61



ELESA and GANTER models all rights reserved in accordance with the law. Always mention the source when reproducing our drawings.

**STANDARD MACHINE ELEMENTS WORLDWIDE**